

Welcome home to a welcome change

in the Primrose. It's manageable one-level living that is **remarkably spacious**, with the option to add more bedrooms on the lower level, for a total of 4, plus rec room. The first floor owner's suite is as grand as most in our larger home plans, with a soaking bath, separate shower, his and her vanities, and a walk-in closet. On to the kitchen, where a **center island and open dining area** make preparing and serving meals a breeze. The gathering room, meanwhile, adds an element of grand style with **beautiful arch details** separating the kitchen and plenty of light pouring in from its many windows. No doubt about it, the Primrose blooms with style, smart design, and sensible expandability.

Bedrooms	2 - 4
Bathrooms	2 - 3
<hr/>	
Total Conditioned Space	2880
Main Floor	1376
Lower Level	1069
Garage	435
<hr/>	
Total	2880



185 44th street Suite D • Grandville, MI 49418
616-667-3333 • bosgraaf.com



FLIP IT. COLOR IT. IT'S YOUR HIGH PERFORMANCE HOME!

All of Bosgraaf's home plans can be "flipped" with the garage on either side. Colors, inside and out, are up to you, as well. You can even decide to invest in optional features such as a third garage stall, or other enhancements. Even though we offer "pre-designed" home choices, *we believe the only place for cookie cutters is in your kitchen drawer!*



185 44th street Suite D · Grandville, MI 49418
616-667-3333 · bosgraaf.com

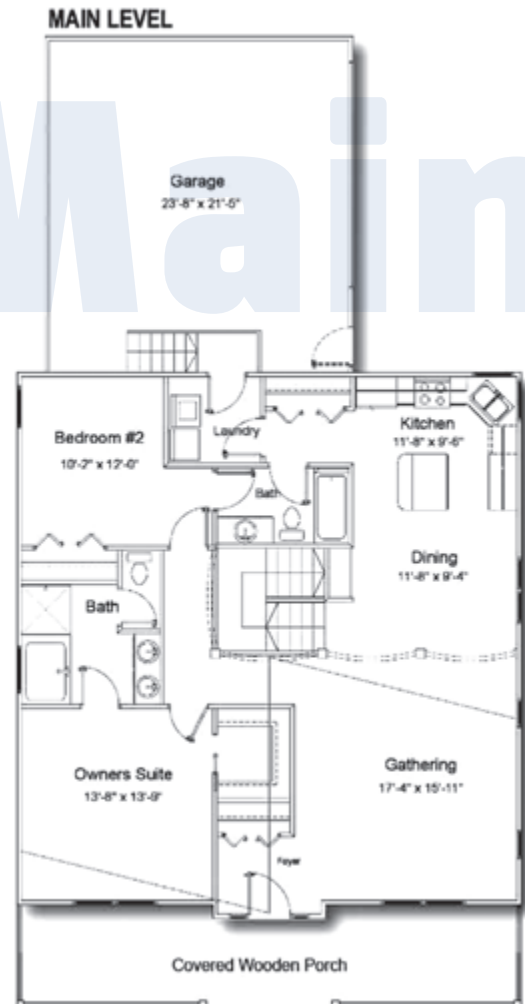
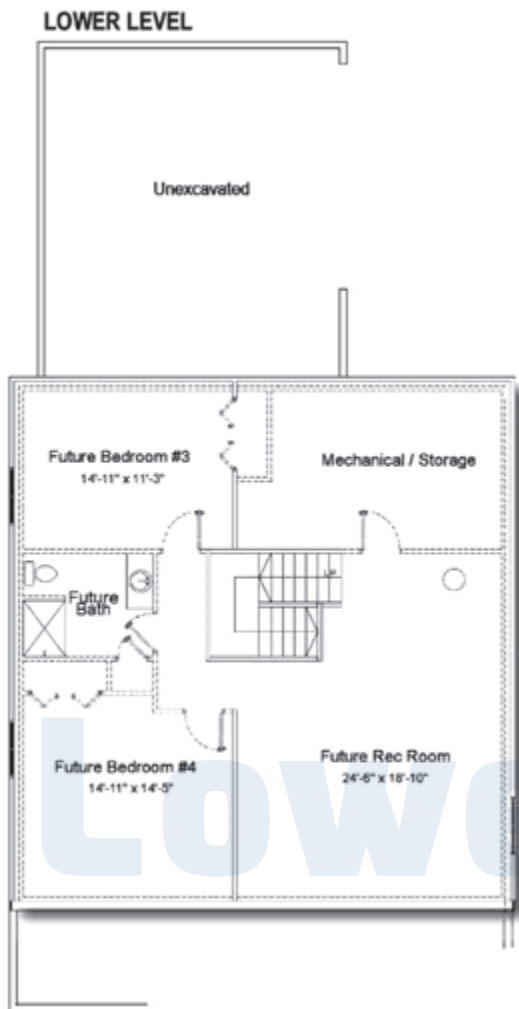



185 44th street Suite D • Grandville, MI 49418
616-667-3333 • bosgraaf.com

